

MANUAL OF INSTALLING KSOL-1 UNIVERSAL CONSTRUCTION FOR AN ADDITIONAL KS2000/2100/2300/2500/2600 COLLECTOR

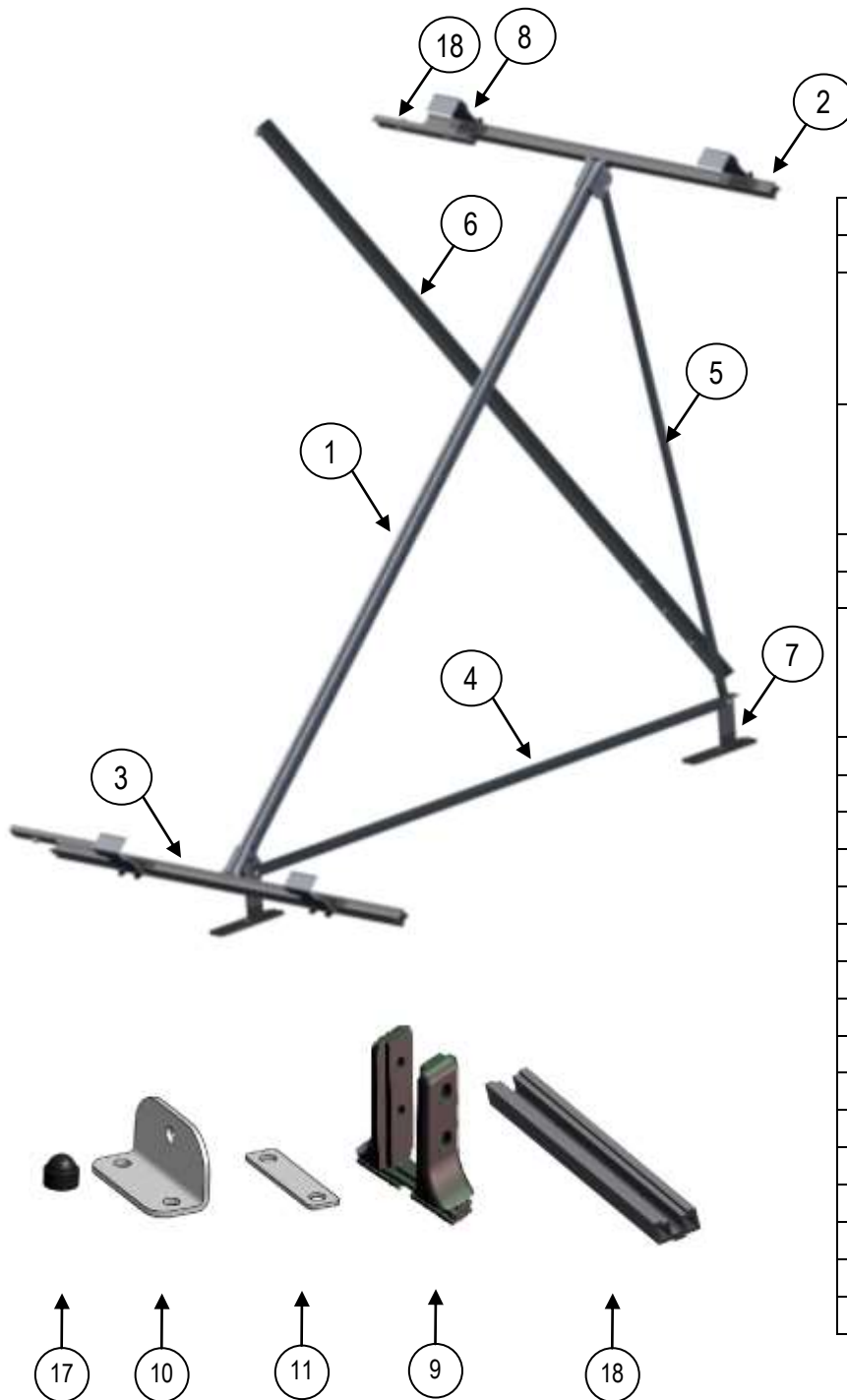

| No | Name | Mount |
|----|--|-------|
| 1 | Vertical profile (1930mm) | 1 |
| 2 | Upper horizontal profile: KS2000/2100 (1085mm) KS2300 (1190mm) KS2500 (1295mm) KS2600 (1362mm) | 1 |
| 3 | Lower horizontal profile: KS2000/2100 (1085mm) KS2300 (1190mm) KS2500 (1295mm) KS2600 (1361mm) | 1 |
| 4 | Bottom connector (1635mm) | 1 |
| 5 | Back connector (1372mm) | 1 |
| 6 | Diagonal connector: KS2000/2100 (1678mm) KS2300 (1748mm) KS2500 (1816mm) KS2600 (1871mm) | 1 |
| 7 | Base | 2 |
| 8 | Collector grasper | 4 |
| 9 | Connector AI | 2 |
| 10 | Angle connector | 2 |
| 11 | Insert | 2 |
| 12 | Screw M6x40 | 4 |
| 13 | Nut M6 | 4 |
| 14 | Screw M8x20 | 9 |
| 15 | Washer Ø8 | 21 |
| 16 | Nut M8 | 9 |
| 17 | Nut cap | 4 |
| 18 | Straight connector | 2 |
| 19 | Screw M8x14 | 4 |
| 20 | Screw M8x25 | 4 |
| 21 | Square nut | 8 |
| 22 | Screw M8x16 | 4 |



The assembly of the KSOL-1 universal construction for an additional collector should be done similarly to the assembly of the KSOL-2 universal construction for two collectors.

The KSOL-1 universal construction is used to mount an additional KS2000-KS2600 collector on the base of KSOL-2 universal construction.

Steps of the assembly:

1. Insert and screw the straight connectors (18) to the horizontal profiles (2 and 3) (on the other side than the collector graspers (8)). Insert the connectors AI (9) to the horizontal profiles (2 and 3).
2. Attach the upper horizontal profile (2) and the lower one (3) (with additional shelf) to the vertical profile (1).
3. Attach the bases (7), bottom connector (4) and back connector (5). Connect the horizontal profiles (2 and 3) with the KSOL-2 frame using angle connectors (10), screws (12) and nuts (13). Using the diagonal connector (6) attach the KSOL-1 structure to the KSOL-2 structure.
4. During the assembly, remove the upper collector graspers (8).
5. Place the solar collectors on the frame's platform, keeping a distance of 85mm between the collectors.
6. Put on and screw tight the top graspers (8) of the collector.
7. Slide the collector to strictly adhere to the lower horizontal profile (3), screw tight the bottom graspers of the collector (8) and put caps on the nuts (17).
8. Using M8x16 screws (22) fasten the collector to the bottom graspers (using rivet nuts mounted in the collector).
9. Push in and screw tight the upper graspers of the collector (8) and put caps on the nuts (17).
10. Using M8x16 screws (22) fasten the collector to the upper graspers (using rivet nuts mounted in the collector).